

A3

DO NOT SCALE

File: CP1770-BLP-ZZ-ZZ-M2-MA-0006-02 SECTION 10 CONSENT MAP.dwg
Date: Apr 14, 2020 - 3:53pm
Plotted by: TUOConnell

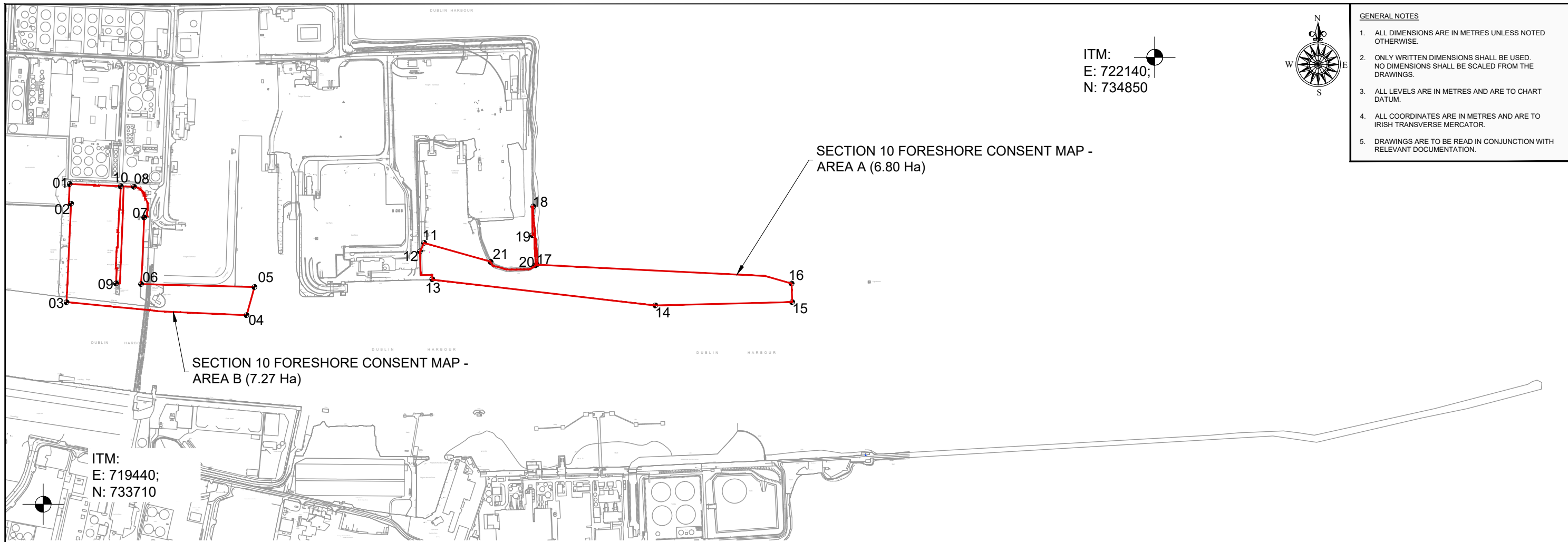

- GENERAL NOTES
1. ALL DIMENSIONS ARE IN METRES UNLESS NOTED OTHERWISE.
 2. ONLY WRITTEN DIMENSIONS SHALL BE USED. NO DIMENSIONS SHALL BE SCALED FROM THE DRAWINGS.
 3. ALL LEVELS ARE IN METRES AND ARE TO CHART DATUM.
 4. ALL COORDINATES ARE IN METRES AND ARE TO IRISH TRANSVERSE MERCATOR.
 5. DRAWINGS ARE TO BE READ IN CONJUNCTION WITH RELEVANT DOCUMENTATION.

SECTION 10 FORESHORE BOUNDARY				
Point	ITM Eastings (m)	ITM Northing (m)	Latitude	Longitude
01	719417.329	734532.212	53°20'51.059" N	-6°12'23.246" W
02	719420.964	734482.834	53°20'49.459" N	-6°12'23.117" W
03	719409.536	734235.395	53°20'41.467" N	-6°12'24.070" W
04	719861.219	734203.159	53°20'40.057" N	-6°11'59.707" W
05	719881.089	734273.821	53°20'42.326" N	-6°11'58.537" W
06	719596.461	734281.209	53°20'42.796" N	-6°12'13.907" W
07	719604.443	734448.371	53°20'48.195" N	-6°12'13.248" W
08	719578.609	734525.327	53°20'50.705" N	-6°12'14.540" W
09	719533.712	734282.838	53°20'42.900" N	-6°12'17.295" W
10	719545.616	734526.648	53°20'50.774" N	-6°12'16.321" W
11	720306.828	734384.454	53°20'45.555" N	-6°11'35.380" W

SECTION 10 FORESHORE BOUNDARY				
Point	ITM Eastings (m)	ITM Northing (m)	Latitude	Longitude
12	720296.314	734363.281	53°20'44.879" N	-6°11'35.977" W
13	720327.319	734293.174	53°20'42.587" N	-6°11'34.397" W
14	720887.042	734227.703	53°20'40.011" N	-6°11'4.242" W
15	721230.122	734236.031	53°20'39.997" N	-6°10'45.692" W
16	721228.867	734282.494	53°20'41.501" N	-6°10'45.696" W
17	720589.3	734329.903	53°20'43.559" N	-6°11'20.191" W
18	720580.709	734475.859	53°20'48.287" N	-6°11'20.455" W
19	720578.75	734403.729	53°20'45.956" N	-6°11'20.660" W
20	720585.959	734328.222	53°20'43.508" N	-6°11'20.374" W
21	720473.341	734337.096	53°20'43.888" N	-6°11'26.447" W

Section 10 - Foreshore Consent (14.07Ha)
Boundary Co-Ordinates

Ordnance Survey Ireland Licence No. EN 0061920
© Ordnance Survey Ireland/Government of Ireland

Drawing Prepared By:

ADAM CRONIN B.Eng., M.Sc. MIEI, C.Eng.
Chartered Engineer
Foreshore Reference No: FS006893
28 February 2020

Rev	Description	By	Date	Chk'd	Auth
02	FORESHORE APPLICATION	PM	04.20	SMC	AC
01	INTERIM ISSUE	PM	03.20	SMC	AC
00	DRAFT FOR APPROVAL	PM	10.19	SMC	AC

ATKINS
Member of the SNC-Lavalin Group

BYRNELOOBY
WS Atkins Ireland Ltd. & ByrneLooby Partners Ltd.
Atkins House
150 Airside Business Park,
Swords, Co. Dublin

Client: **COMHLACHT CHALAPORT ÁTHA CLIATH DUBLIN PORT COMPANY**

Project: **MP2 PROJECT**

FORESHORE				
SECTION 10 CONSENT MAP				
Original Scale	Design/Drawn	Checked	Authorised	
1:10,000 @A3	PM	SMC	AC	
Date	Date	Date	Date	
24/09/19	24/09/19	24/09/19	24/09/19	
Status	Drawing Number	Rev		
FS	CP1770-BLP-ZZ-ZZ-M2-MA-0006	02		