

A3

DO NOT SCALE

File: CP1770-BLP-04-ZZ-M2-MA-0404-02 Cross Section J-J through Berth 53 Dredging.dwg
Date: Apr 14, 2020 - 4:16pm
Plotted by: TJOConnell

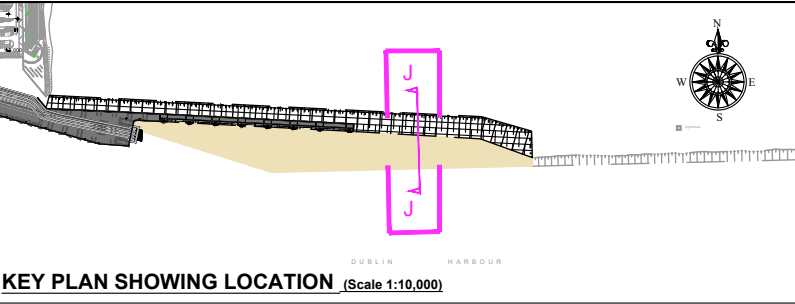
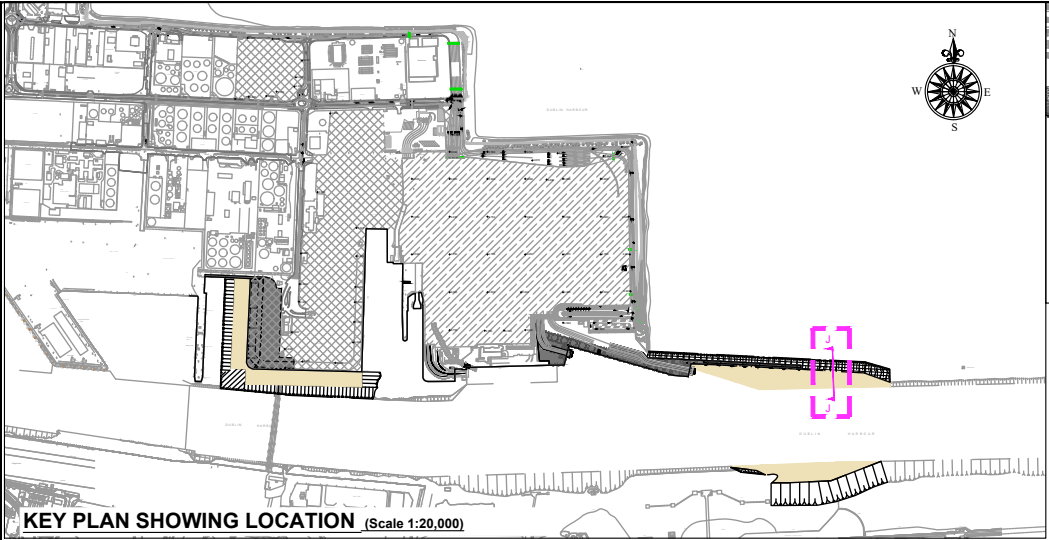

- GENERAL NOTES**
1. ALL DIMENSIONS ARE IN METRES UNLESS NOTED OTHERWISE.
 2. ONLY WRITTEN DIMENSIONS SHALL BE USED. NO DIMENSIONS SHALL BE SCALED FROM THE DRAWINGS.
 3. ALL LEVELS ARE IN METRES AND ARE TO CHART DATUM UNLESS NOTED OTHERWISE.
 4. ALL COORDINATES ARE IN METRES AND ARE TO IRISH TRANSVERSE MERCATOR.
 5. DRAWINGS ARE TO BE READ IN CONJUNCTION WITH RELEVANT REPORTS.
 6. ALL DRAWINGS ARE THE PROPERTY OF ATKINS BYRNELOOBY.
 7. [xx.xx m CD] REFER TO LEVELS AT CHART DATUM (DUBLIN PORT).
 8. ORDNANCE DATUM MALIN [O.D.M.].
 9. OS MAP SHEET NO:
3198-18, 3198-19, 3198-20, 3198-23, 3198-24, 3198-25, 3199-16, 3199-17, 3199-18, 3199-21, 3199-23, 3199-24, 3264-2, 3264-3, 3264-4, 3264-5, 3264-8, 3264-9, 3264-10, 3264-13, 3264-14, 3264-15, 3265-1, 3265-6, 3265-7, 3265-8, 3265-9, 3265-11, 3265-12.

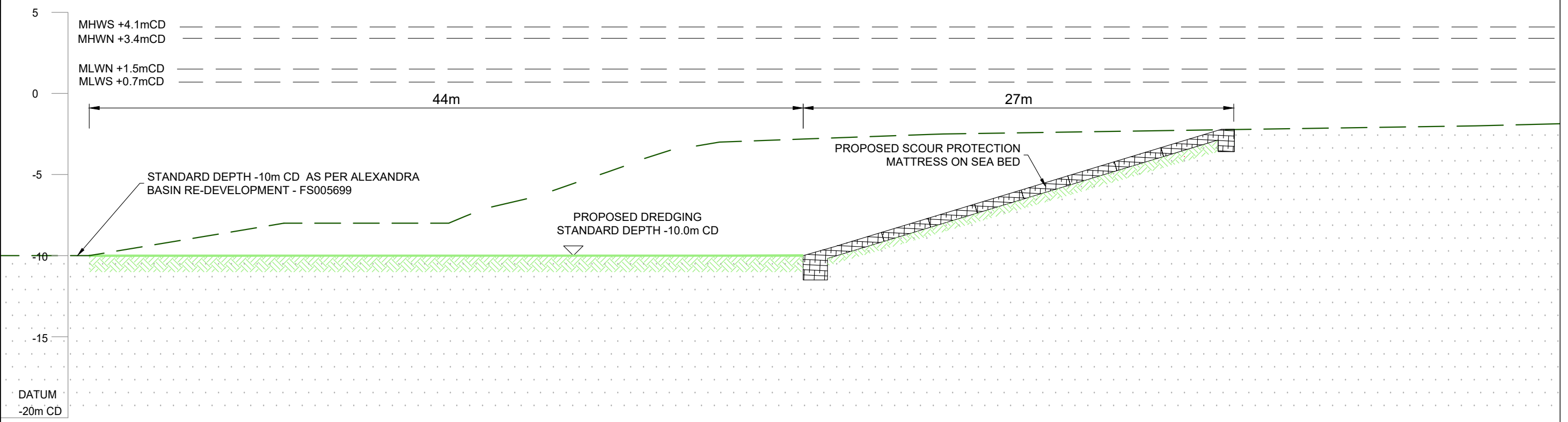

Ordnance Survey Ireland Licence No. EN 0061920
 © Ordnance Survey Ireland/Government of Ireland

	PROPOSED BED LEVEL
	PROPOSED SCOUR PROTECTION MATTRESS ON SEA BED
	DREDGED SIDE SLOPES
	PROPOSED DREDGED AREA
	EXISTING BED LEVEL

Drawing Prepared By:

ADAM CRONIN B.Eng., M.Sc. MIEI, C.Eng.
 Chartered Engineer
 Foreshore Reference No; FS006893
 28 February 2020

Rev	Description	By	Date	Ch'kd	Auth
02	FORESHORE APPLICATION	PM	04.20	SMC	AC
01	INTERIM ISSUE	PM	03.20	SMC	AC
00	DRAFT FOR APPROVAL	TJOC	10.19	SMC	AC

ATKINS
 Member of the SNC-Lavalin Group

BYRNELOOBY
 WS Atkins Ireland Ltd. & ByrneLooby Partners Ltd.
 Atkins House,
 150 Airside Business Park,
 Swords, Co. Dublin

Client

Project
MP2 PROJECT

FORESHORE			
Title CROSS SECTION J-J THROUGH BERTH 53 DREDGING			
Original Scale	Design/Drawn	Checked	Authorised
AS SHOWN @A3	TJOC	SMC	AC
Date	Date	Date	Date
25.09.19	25.09.19	25.09.19	25.09.19
Status	Drawing Number		Rev
FS	CP1770-BLP-04-ZZ-M2-MA-0404		02