

A3

DO NOT SCALE

File: CP1770-BLP-04-ZZ-M2-MA-0403-02 Cross Section I-I at Channel Widening.dwg
Date: Apr 15, 2020 - 9:10am Plotted by: TJOCConnell

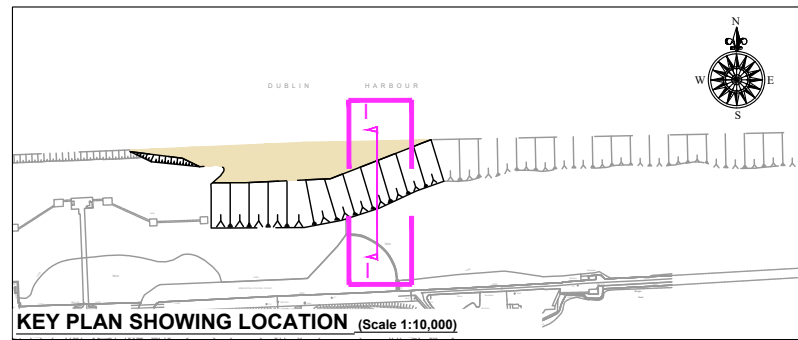
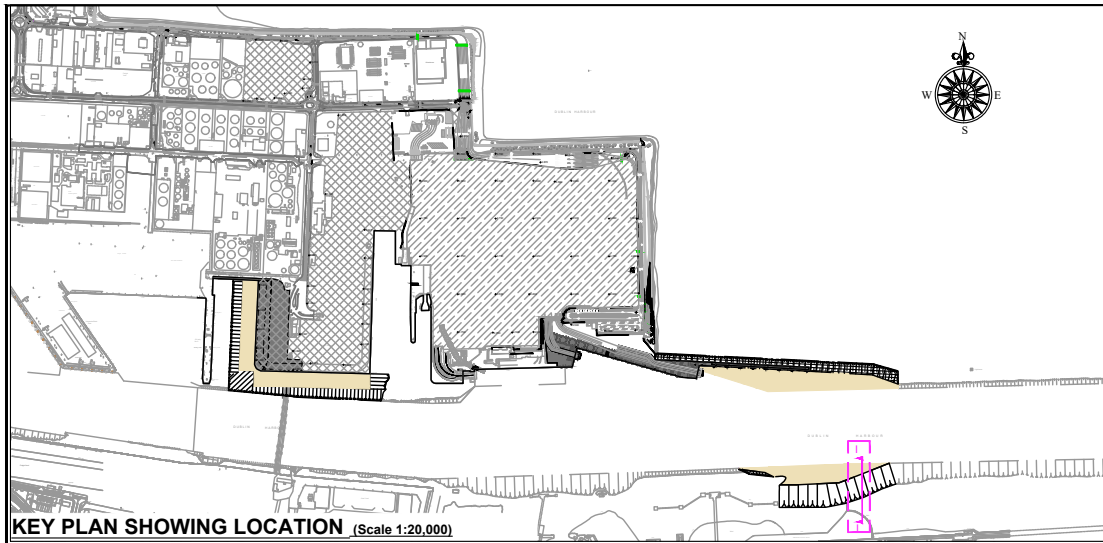

- GENERAL NOTES**
1. ALL DIMENSIONS ARE IN METRES UNLESS NOTED OTHERWISE.
 2. ONLY WRITTEN DIMENSIONS SHALL BE USED. NO DIMENSIONS SHALL BE SCALED FROM THE DRAWINGS.
 3. ALL LEVELS ARE IN METRES AND ARE TO CHART DATUM UNLESS NOTED OTHERWISE.
 4. ALL COORDINATES ARE IN METRES AND ARE TO IRISH TRANSVERSE MERCATOR.
 5. DRAWINGS ARE TO BE READ IN CONJUNCTION WITH RELEVANT REPORTS.
 6. ALL DRAWINGS ARE THE PROPERTY OF ATKINS BYRNELOOBY.
 7. [xx.xx m CD] REFER TO LEVELS AT CHART DATUM (DUBLIN PORT).
 8. ORDNANCE DATUM MALIN [O.D.M.].
- CHART DATUM [C.D.] (DUBLIN PORT) 2.51m
9. OS MAP SHEET NO:
3198-18, 3198-19, 3198-20, 3198-23, 3198-24, 3198-25, 3199-16, 3199-17, 3199-18, 3199-21, 3199-23, 3199-24, 3264-2, 3264-3, 3264-4, 3264-5, 3264-8, 3264-9, 3264-10, 3264-13, 3264-14, 3264-15, 3265-1, 3265-6, 3265-7, 3265-8, 3265-9, 3265-11, 3265-12.

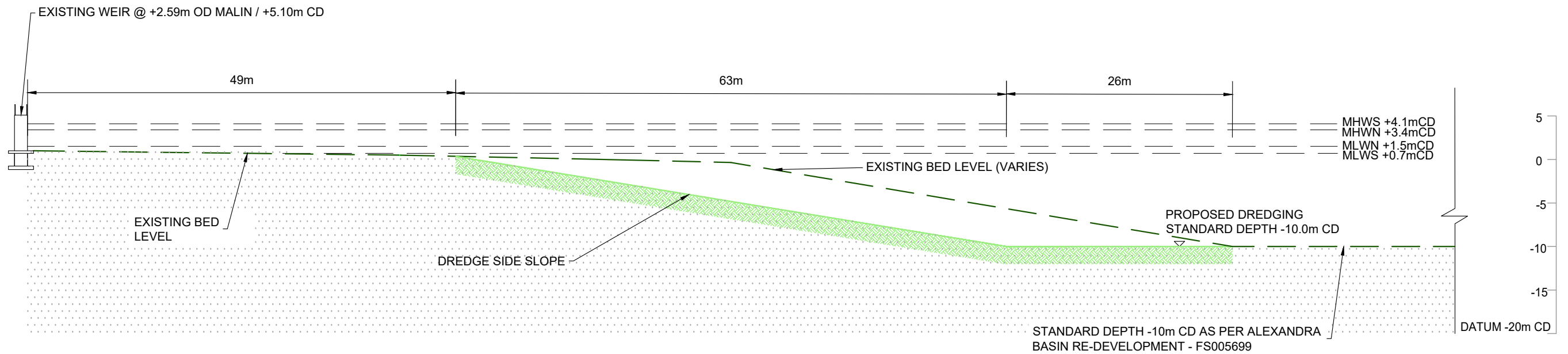

CROSS SECTION I-I (Scale 1:500)

Ordnance Survey Ireland Licence No. EN 0061920
© Ordnance Survey Ireland/Government of Ireland

- PROPOSED BED LEVEL
- PROPOSED SCOUR PROTECTION MATTRESS ON SEA BED
- DREDGED SIDE SLOPES
- PROPOSED DREDGED AREA
- EXISTING BED LEVEL

Drawing Prepared By:

Adam Cronin

ADAM CRONIN B.Eng., M.Sc. MIEI, C.Eng.
Chartered Engineer
Foreshore Reference No; FS006893

28 February 2020

Rev	Description	By	Date	Chk'd	Auth
02	FORESHORE APPLICATION	PM	04.20	SMC	PM
01	INTERIM ISSUE	PM	03.20	SMC	PM
00	DRAFT FOR APPROVAL	TJOC	10.19	SMC	AC

ATKINS
Member of the SNC-Lavalin Group

BYRNELOOBY
WS Atkins Ireland Ltd. & ByrneLooby Partners Ltd.
Atkins House,
150 Airside Business Park,
Swords, Co. Dublin

Client
COMHLACHT CHALAFORT
ÁTHA CLIATH
DUBLIN PORT COMPANY

Project
MP2 PROJECT

FORESHORE			
Title CROSS SECTION I-I AT CHANNEL WIDENING (SOUTH OF EXISTING NAVIGATION CHANNEL)			
Original Scale AS SHOWN @A3	Design/Drawn TJOC Date 25.09.19	Checked SMC Date 25.09.19	Authorised AC Date 25.09.19
Status FS	Drawing Number CP1770-BLP-04-ZZ-M2-MA-0403	Rev 02	